

**PILOT PISTON ASSEMBLIES**
**DESCRIPTION**

These pistons are used in a manifold to create pilot operated valve assemblies, such as pilot operated checks.

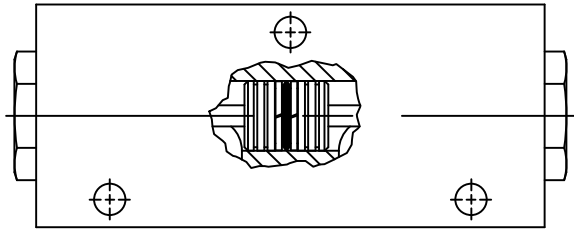

**FEATURES**

- O-rings on piston are optional.
- One piece design or pressed fit dowel pins
- Single or double pilot piston options.

**PISTON SPECIFICATIONS**

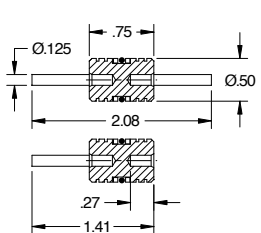
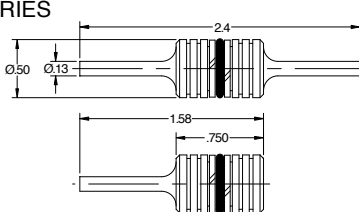
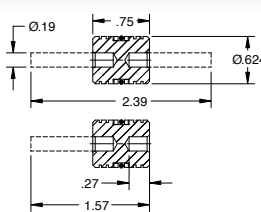
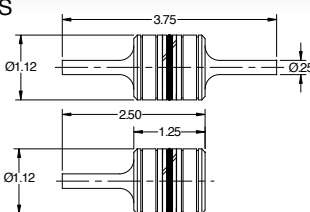
| VALVE SERIES | SEAT DIAMETER | PILOT RATIO |
|--------------|---------------|-------------|
| MINI         | .193          | 6.7:1       |
| POWER        | .250          | 4:1         |
| DELTA        | .312          | 4:1         |
| SIXTEEN      | .590          | 3.7:1       |

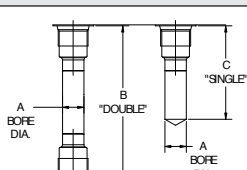
|  |  |
|--|--|
| <b>MINI SERIES</b><br>   | <b>POWER SERIES</b><br>    |
| <b>DELTA SERIES</b><br> | <b>SIXTEEN SERIES</b><br> |

| CAVITY INFORMATION  | SERIES  | BORE DIAMETER | DOUBLE - SPOTFACE DIM. | SINGLE - SPOTFACE DIM. |
|---|---------|---------------|------------------------|------------------------|
|   |         | A             | B                      | C                      |
|  | MINI    | .500/.502     | 3.313                  | 2.031                  |
|   | POWER   | .500/.502     | 4.250                  | 2.406                  |
|   | DELTA   | .625/.627     | 4.500                  | 2.750                  |
|   | SIXTEEN | 1.126/1.128   | 6.938                  | 4.000                  |

**ORDERING INFORMATION**

|                         |               |  |                |  |                          |
|-------------------------|---------------|--|----------------|--|--------------------------|
|                         | <b>PISTON</b> |  | <b>SEALS</b>   |  | <b>PILOT PIN OPTIONS</b> |
| MINI Series .500 DIA    | <b>M</b>      |  | <b>B</b> Buna  |  | <b>S</b> Single          |
| POWER Series .500 DIA   | <b>P</b>      |  | <b>V</b> Viton |  | <b>D</b> Double          |
| DELTA Series .625 DIA   | <b>D</b>      |  | <b>O</b> Omit  |  |                          |
| SIXTEEN Series 1.12 DIA | <b>S</b>      |  |                |  |                          |

**WARNING:** the specifications/application data shown in our catalogs and data sheets are intended only as a general guide for the product described (herein). Any specific application should not be undertaken without independent study, evaluation, and testing for suitability.